

CIVIL ENGINEERS
LAND SURVEYORS
DEVELOPMENT CONSULTANTS
GEOELECTRICAL
ENVIRONMENTAL
CONSTRUCTION STAKING
CONSTRUCTION MAT. TESTING

TERRA
SITE DEVELOPMENT

16102 Spring Hill Road Westfield, Indiana 46074
P: 317.397.1216 F: 317.397.1216
www.TERRAind.com

PROPOSED LEGEND

HYDRANT	FD	FOUNDATION DRAIN
VALVE	TV	CABLE TV LINE**
TEE	E	ELECTRIC LINE**
ADAPTER	FO	FIBER OPTIC LINE
BEND	SSD	SUB-SURFACE DRAIN
TEMP. FLUSH HYDRANT	UD	STORM UNDERDRAIN
BLOW-OFF	STM	STORM SEWER
THRUST BLOCK	SAN	SANITARY SEWER
PLUG	FM	FORCE MAIN
REDUCER	G	GAS LINE
M.J. SLEEVE	T	TELEPHONE LINE**
CROSS	W	WATER LINE
WATER METER	8"W	8" W WATER LINE
POST INDICATOR VALVE		
FIRE CONNECTION		
TRANSFORMER PAD		
RELOCATED ELECTRIC/TELEPHONE POLE		
SIGN		
HANDICAP PARKING		
CLEAN OUT		
STORM CHAMBER		
SANITARY MANHOLE		
STORM MANHOLE		
STORM COMBINATION INLET		
STORM GRATE INLET		
STORM BEEHIVE/YARD DRAIN		
STORM GRATE INLET		
BMP		

**PREFIX FOR UTILITY LINES:
UG - UNDERGROUND
OH - OVERHEAD

KEY NOTES:

- (A) ROADSIDE TRAIL PAVEMENT
- (B) EXISTING HYDRANT TO REMAIN
- (C) RELOCATED POWER POLE
- (D) POWER POLE TO REMAIN

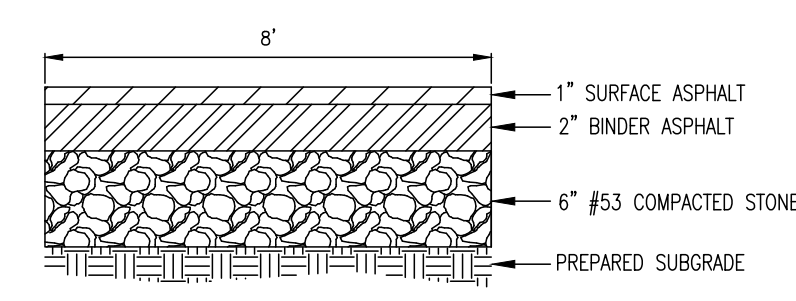
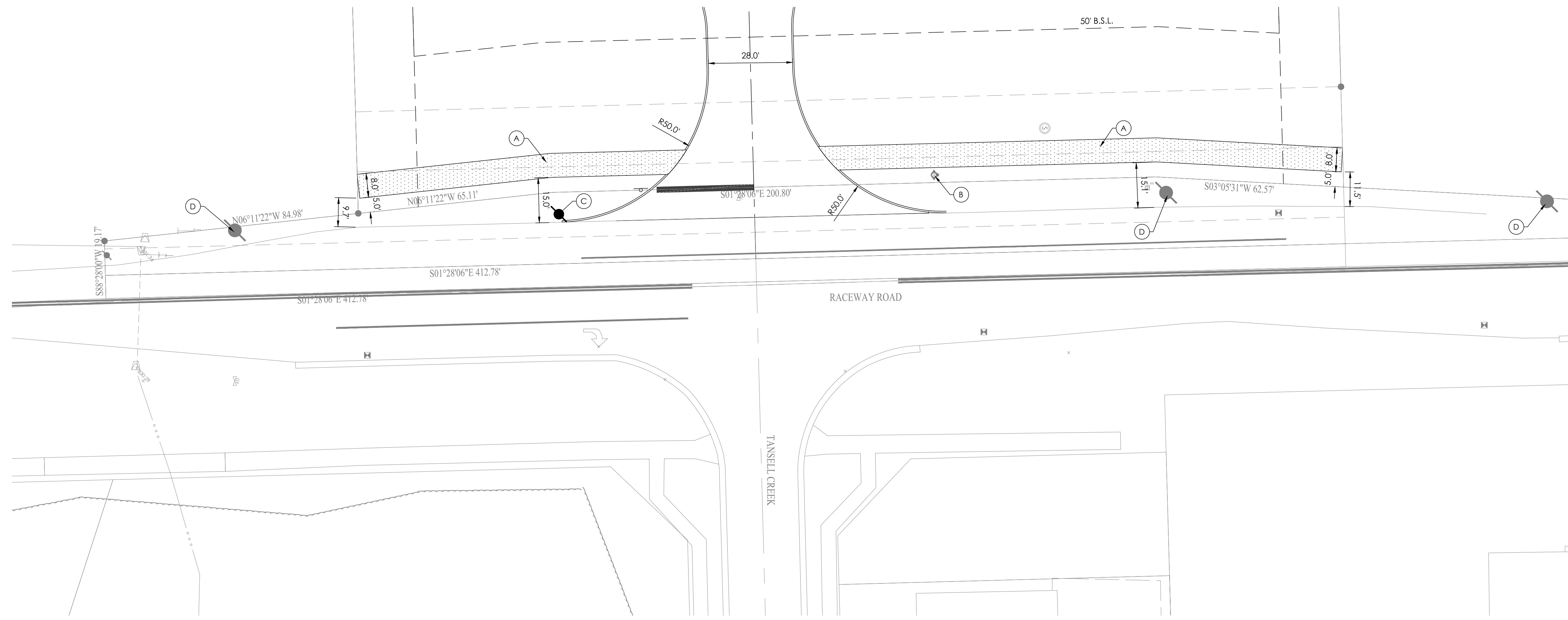

ROADSIDE TRAIL SECTION
NOT TO SCALE

WARNING: CONTRACTOR TO VERIFY PRESENCE AND EXACT LOCATION OF ALL UTILITIES PRIOR TO CONSTRUCTION.

NOTE: ALL SANITARY SEWER SHALL CONFORM TO CURRENT HENDRICKS COUNTY REGIONAL SEWER DISTRICT STANDARDS.

NOTE: ALL WORK TO CONFORM TO CURRENT CITY OF BROWNSBURG UTILITY AND INFRASTRUCTURE STANDARDS AND SPECIFICATIONS.

NOTE: ALL WATER MAIN CONSTRUCTION SHALL CONFORM TO CURRENT CITIZENS ENERGY STANDARDS.

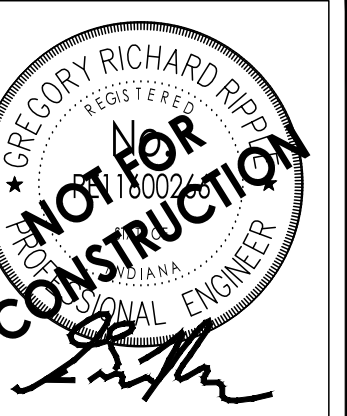

COMPASS AND KEY INDUSTRIAL PARK

2616 N RACEWAY RD., BROWNSBURG, IN 46234
SEC. 29 - T16N - R2E - J16C01 W/4 - HENDRICKS COUNTY INDIANA

COMPASS AND KEY LLC
9129 LOG RUN DR S., INDIANAPOLIS, IN 46234

MULTI-USE PATH PLAN

PLAN DATE: 01/27/26
DESIGN: KLS CHECK: GRR DRAWN: KLS
PROJECT NO: 2504018
SHEET NO: **C220**



Y:\Project\2025\2504018\CompassIndustrialPark_Jacobs\GIS\CAD\MOON\CAD\02\sheet\C220.dwg Plot: February 4, 2026 12:42:07 PM